

# CLUB CAR REGEN 1 WIRING DIAGRAM (FX302)

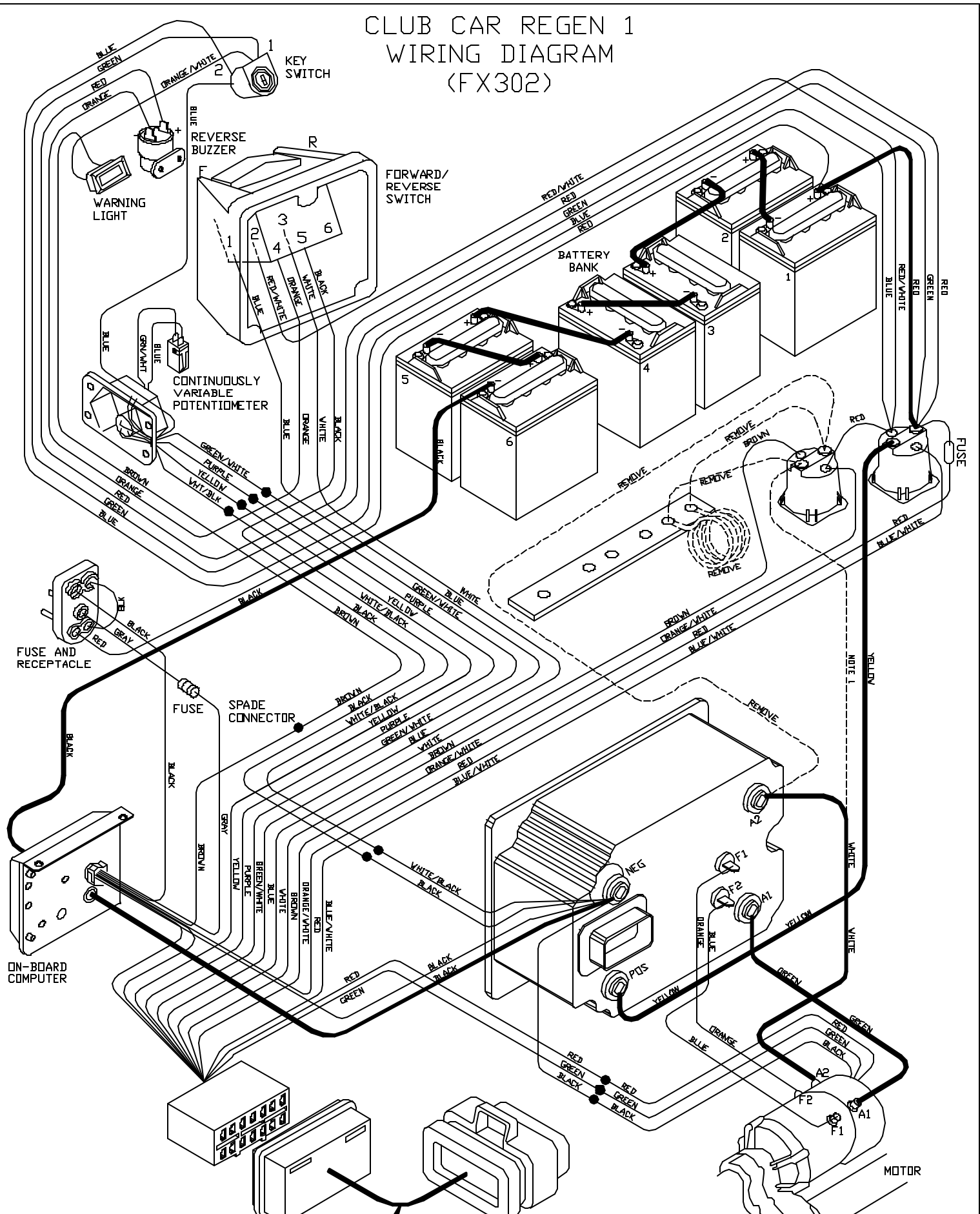

NOTES:  
1.) REMOVE WHITE WIRE FROM THE SOLENOID POST (AS INDICATED BY DOTTED LINE) AND RECONNECT TO A2 OF THE CONTROL

ADAPTER HARNESS FOR FX CONTROLLER